

Beilage Nr. 15.4

 Departement Bau, Verkehr und Umwelt  
Abteilung Tiefbau

GEMEINDE: Teufenthal IO

STRASSE: K 242 / K 250

OBJEKT: Knotenumbau in Kreisel  
Einmündung Schmittengasse  
Submissionsbeilage

PLAN: Bauphase 3

EDV-Pfad: ...A\_Ausführungsprojekte\_Planen\ Submissions\_Installationspläne\chwg  
Dokument-Nr.: 4145PLF100  
Datum: 07.09.2018

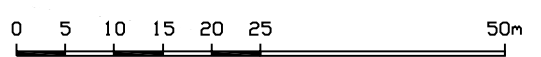
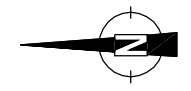

 Fussgängerführung

 Umleitung  
LKW zur Schmittengasse

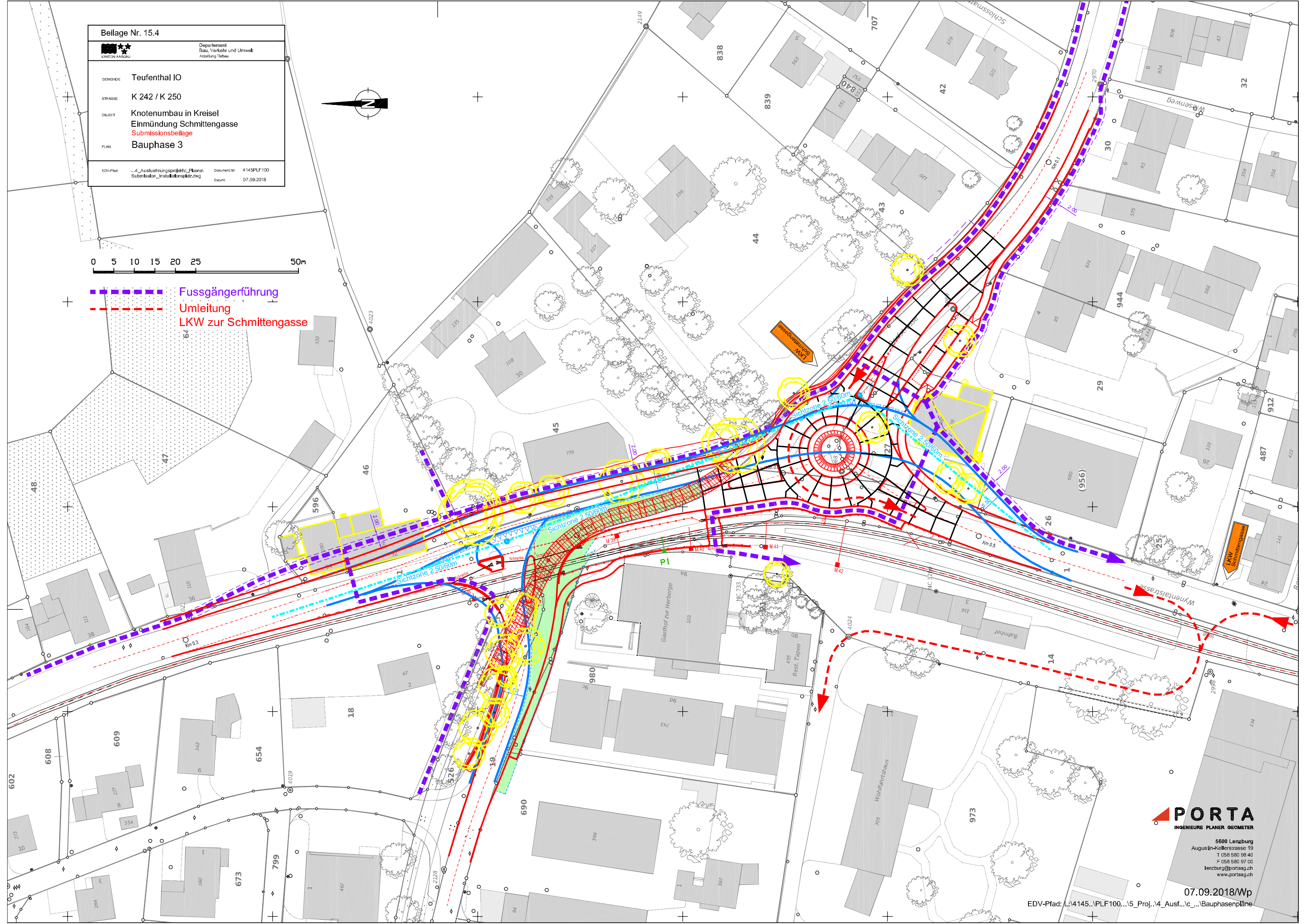

**PORTA**  
INGENIEURE PLANER GEOMETER

5600 Lenzburg  
Augustin-Kellerstrasse 19  
T 058 580 98 40  
F 058 580 97 00  
lenzburg@portaag.ch  
www.portaag.ch